



Applications:

S-Type load cell Type BM₃, oil-proof, water-proof, anti-corrosion, can be used in low and medium weighing systems.

Some applications are:

- Stainless steel, hermitically welded, oil-proof, waterproof and anti-corrosion, suitable for all kinds of environment
- Safe and anti-explosive product, can be used in atrocious environment and hazardous areas
- S beam design, tension and/or compression loading possible, easy installation, suitable for electronic crane scales, hopper scale and other devices

Main features

- High accuracy
- Stainless steel construction
- Low profile
- PTB approval No.: D09-08.01
- Accessory: HL-3-001; HL-3-002
HL-3-003; HL-3-004; HL-3-005

Nominal Load:

Kg: 50, 100, 150, 200, 250, 500
t: 1, 2, 3, 4, 5, 6, 7.5



**S-TYPE
LOAD CELL
TYPE BM3**

Specifics according to VDI/VDE 2637

Metrological Characteristics	Par.	Un.	C3	OIML R60 C3
Nominal Load	Ln	t	0,05÷0,25	025÷7,5
Initial Load	Lp	%Ln		20
Maximum Load	Ll	%Ln		150
Combined Error	Fv	±%Ln		0,023
Creep in 30'	Fcr	±%Ln		0,016
Nominal Temperature Range	Btn	°C		-10+40
Zero Temperature Drift (10÷60°C, over 10°C)	TKo	±%Cn		0,011
output Temperature Drift (10÷60°C, over 10°C)	TKC	±%Cn		0,015
Thermal Gradient		K/h		<5

Electrical Data				
Nominal Output	Cn	mV/V	2	2
Nominal Output Tolerance	Dc	±%Cn	0,4	0,2
Nominal Supply Voltage	Bsu	V		5÷12
Maximum Supply Voltage	Usmax	V		18
Input Resistance	Re	Ω		350±3%
Output Resistance	Ra	Ω		350±3%
Insulation Resistance @ 20V	Ris	MΩ		>5000
Zero Output Resistance	Do	±%Cn		1,5

Mechanical Data				
Breaking Load	Ld	%Ln		300
Maximum Side load	Llq	%Ln		100
Deflection	hn	mm		<1
Cable Length		mm	6000	6000 (3000 per 500kg)
Weight		Kg		

Environmental Conditions				
Working Temperature Range	Btn	°C		-35+65
Storage Temperature Range	Bts	°C		-40+70
Housing Protection				IP -68

Subject to change without notice

Dimensions: (in mm; 1mm = 0.03937 inch)

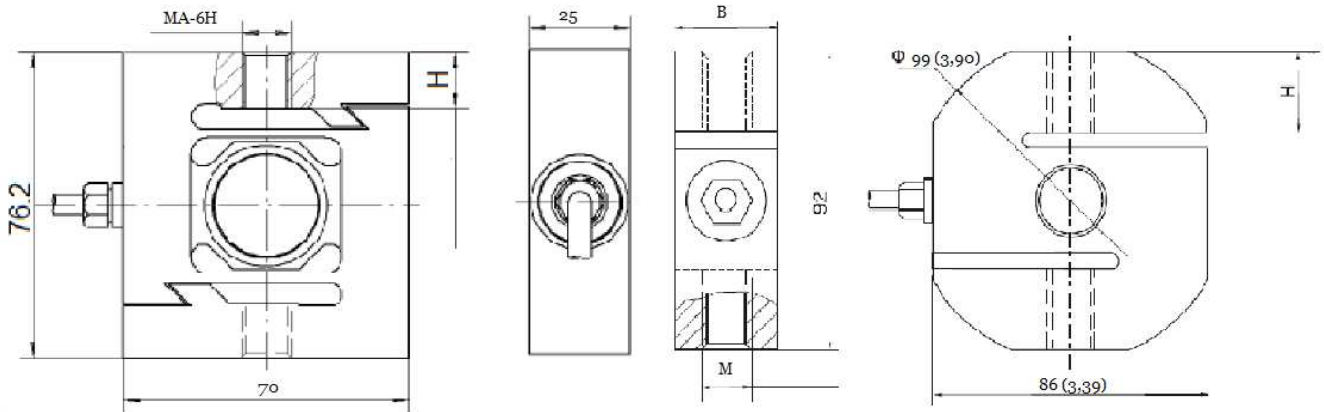

Dimensions Capacity	MA	H
50kg, 100kg	M8	13
150kg - 250kg	M12 x 1.75	14

Dimensions Capacity	B	H	M
0.5t, 1t	32	25	M12 x 1.75
2t, 3t	32	25	M20 x 1.5
4t	36	25	M20 x 1.5
5t, 6t, 7.5t	50	24	M24 x 2

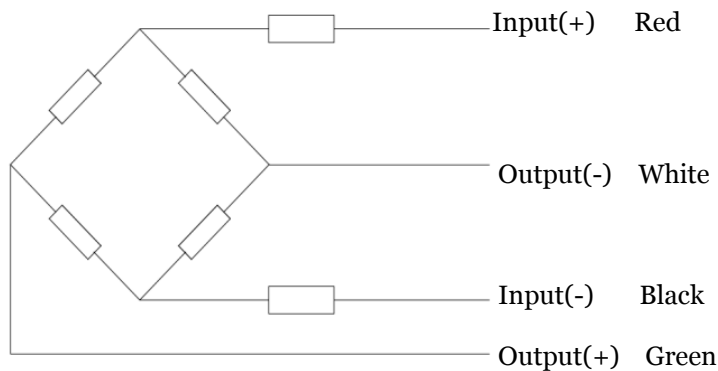

Wiring:

- Shielded, 4 conductor cable
- Cable diameter: Ø 5mm.
- Standard cable length: all 6m, except 500Kg: 3m
- Shield not connected to the element